

# 麓湖云朵乐园

Luxe Lake Cloud Park

撰文/图片提供 上海张唐景观设计事务所

翻译 张海 周啸



成都麓湖不是一个天然湖，而是一个巨大的人造雨水生态系统。十多年前成都麓湖还是一片谷地，开发商引入了都江堰的水源并通过生态治理形成了如今的“珊瑚”状清澈水域。设计师加入的时候，湖面已经建成，效果非常好。湖上可以进行各种水上活动，湖周围的建筑和桥独特而有魅力。

设计师对滨湖水政绿地进行改造时，首先考虑的是麓湖还需要什么。显然，作为一块城市用地，麓湖应该为人们日常生活提供活动的空间。通过对麓湖引水造湖的历史的解读，以及对一期的现状分析，设计师将场地定位为“寓教于乐”的儿童乐园，就像是一个露天的自然博物馆，以水的各种形态和特征作为设计灵感，设计出景观空间，在科普与水有关的知识的同时赋予这个作品以鲜明的个性。

**“世界之眼”**： “世界之眼”由设计师改造而成，包括根据地形设计的小型剧场、小型服务建筑和倒影水台。由于湖面建设已经完成，改造工作只能在现有湖岸的基础上进行。倒影水台中铺装的石材在高度和色彩等方面有着明显的变化，分别代表着陆地和海洋。

**“冰凌拱桥”**： 为了确保沿湖的流线性，设计师在这里新增了一座桥，鉴于通航需求，便将它设计成拱桥。桥体内部暗藏LED灯和感应器，人们行走在桥上，灯光会随人们的行走轨迹变化。桥面用镜面不锈钢管装饰，可以反射出周边的环境。

**“冰川峡谷”**： 设计师在原有挡土墙和树木的基础上进行了调整。设计师受冰川峡谷的启发，运用三角面结构组成的镜面墙反射天光，还配置了暗藏的声音感应装置，当行人穿过时，会听到类似水滴在峡谷中回响的声音。

**“跳跳云”**： 一朵巨大的“白云”落在湖边小岛。在这个巨大的、内部充气的新奇蹦床上，孩子们可以享受腾云驾雾的感觉。

**“早喷广场”**： 利用互动装置激发的早喷泉可以更好地增加人与人、人与自然之间的互动。而且再也不会出现人们乘兴而来,结果喷泉没有打开的情况了。人们想玩水,只需要激活装置就可以尽享泉水之乐。

**“曲溪流欢”**： 这是一个结合消防通道的改造建设。早喷广场喷出的水汇聚在广场中央，顺地形流下来，自然地形成一条蜿蜒曲折的小溪。

**“互动涌泉”**： 溪流在平坦处汇集成一个浅浅的池塘，小朋友可以安全地进入并且玩耍。水池中有七个小涌泉，每一个都有相对应的触控开关，这些开关集中设置在一个大石台上，可以由游玩者自行控制。

**“冰雪滑梯”**： 设计师利用场地的山坡地形设置了一组游戏设施，包括空中环形走廊、旋转楼梯、沙坑和用白色水磨石建造的滑梯。

**“湿地漫步”**： 设计师在现有水系基础上增加了一处可以出入的湿地花园。在这里，人们可以看到各种水生植物，还可以近距离地观察蝌蚪、青蛙和鱼等动物。

**“巨浪飞渡”**： 跨越湿地的一座桥，设计师用仿木纹铝板将其装饰成巨浪的形态。

**“漩涡爬网”**： 由设计师专门设计的一组活动器械，包括爬网、滚轴滑梯、激光阵、树屋等各种活动设施。在其内部，人们会有漩涡的视觉体验，器械整体造型来源于麓湖的吉祥物——“鹿之角”。

**“水滴剧场”**： 临湖有一个具有雕塑感的建筑，造型来源于一滴水。建筑内部的水滴状座凳由异形镜面不锈钢加工而成，同时座凳还可以转动。





Chengdu luxe lake is not a natural lake, but a huge artificial rainwater ecosystem. The lake used to be a valley a decade ago before the developer introduced and purified water from Dujiangyan. The lake has already been built when designers get involved. The environment is very pleasant. The lake offers a variety of water activities, and the buildings and bridges surrounded are unique and fascinating.

The client asks designers to reconstruct lakeside municipal green space. The first question designers need to answer is "what else the luxe lake needs?" Obviously, as an urban space, the site should provide various activities for daily life. Through careful analysis, designers decide the site to be a children's playground as well as an open-air museum of natural history. The shape and characteristic of water become the inspiration of the cloud park.

**Eye of the World:** This node is an innovation of the existing construction. The design includes small theatre with topography, small service building and waterfront reflection pool. Since the lake has been formed, the transformation can only be carried out based on the present lakeshore. The stone pavement in the reflection pool indicates the land and the sea through differences in height and color.

**The Ice Bridge:** Designers add a bridge in order to ensure a complete pedestrian system. The bridge is an arch due to navigation demand on the lake. LED lights and sensors are hidden inside the bridge. People walk on the bridge and the light changes. The decks are decorated with mirrored stainless steel tubes that reflect the surrounding environment.

**Glacier Canyon:** The design is an adjustment on existing retaining walls and trees. Inspired by the glacier canyon, a triangular mirror wall with hidden sound sensors reflects the skylight. People hear the echoes of water droplets in the canyon when they walk through it.

**Jumping Cloud:** A huge white cloud landed on a small island by

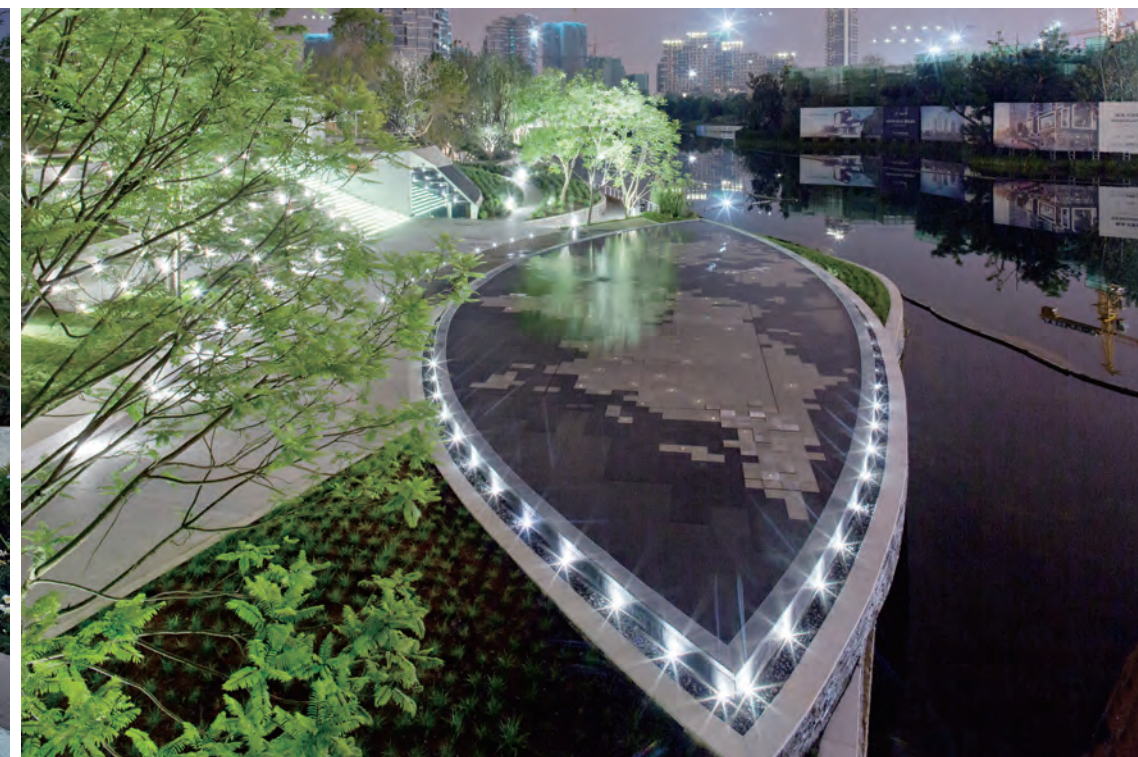



the lake. Children can experience the feeling of being above the clouds when they jump on the giant trampoline.

**Dry Spray Plaza:** The use of interactive devices to trigger drought spray can better enhance the interaction between people and nature. When you want to play the water, you just need to ride on the devices.

**The Happy Stream:** This is a design based on the consideration of fire passage. The water from the dry spray square converged in the middle of the square and flowed down the terrain and then formed a meandering stream that could be fully involved.

**Interactive Spring:** The stream is integrated into a small shallow pond at the foot of the hill. Children can safely enter it and play the water. There are seven small springs, seven touch switches on a large stone table corresponding to each of the springs. The opening and closing of the springs can be controlled by the visitors themselves.

**Ice Slide:** A set of game facilities including sky corridors, rotating staircases, sandpit, and white terrazzo slopes, are set up utilizing hillside terrain.

**Wetland Walk:** An accessible wetland garden is designed based on the existing water system. Here you can see all kinds of aquatic plants, you can watch tadpoles, frogs and fish at close range.

**The Whirlpool Crawl:** This is a group of play instruments specially designed and produced including the crawl, roller slides, laser array, tree house and so on. There is vortex visual experience inside the instrument. The whole instrument for justice takes shape from the deer horn.

**The Flying Waves:** A bridge across the wetland is decorated as waves with wood like aluminium plate.

**Water Drop Theatre:** This is a structure by the side of the lake. It takes the form from a drop of water. The water drop stool inside the structure is made of special-shaped mirror stainless steel and can rotate. **LD**







项目位置：成都麓湖生态城  
委托方：成都万华新城发展股份有限公司  
景观设计：上海张唐景观设计事务所  
装置设计、制作及安装：张唐景观艺术工作室  
占地面积：26 000 m<sup>2</sup>  
设计时间：2016 年 5 月 ~2016 年 12 月  
竣工时间：2017 年 6 月  
摄影：张海、存在建筑、张唐景观

Location: Luxe Lake Eco-city, Chengdu  
Client: Chengdu Wanhua New City Development Co., Ltd  
Landscape Design: Shanghai Z+T Landscape Design Firm  
Equipment Design, Fabrication and Installation: Z+T Studio  
Site Area: 26,000 m<sup>2</sup>  
Design Time: May. 2016 – Dec. 2016  
Completion Time: Jun. 2017  
Photography: Zhang Hai, ExistArch, Z+T Studio

